



## High Power Wireless-N 600mW Range Extender / Smart Repeater

SR10000

### 1 Find an optimal setup location between your wireless router and your wireless dead zone



#### IMPORTANT:

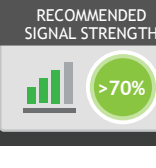

PLACE THE RANGE EXTENDER / SMART REPEATER IN A LOCATION WHERE IT CAN RECEIVE A STRONG SIGNAL FROM YOUR WIRELESS ROUTER

This can be done before or after setup is complete. The Range Extender / Smart Repeater will save your settings.

### 2 Connect your PC to the Range Extender

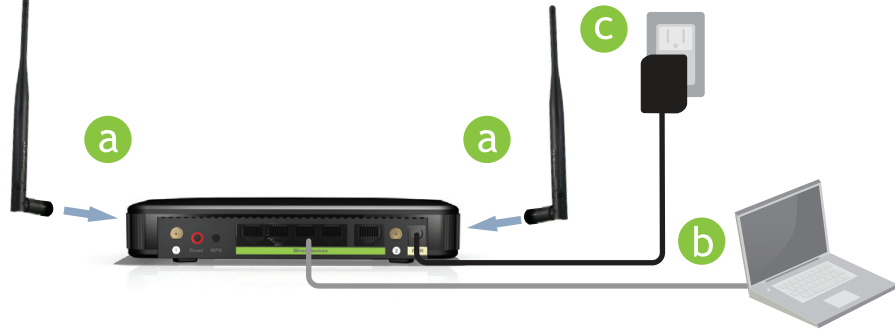

- Attach the two included antennas.
- Connect the included network cable to an available network port on your computer.
- Attach the Power Adapter to the Range Extender's **PWR** port and an available power outlet.

### 3 Open your web browser

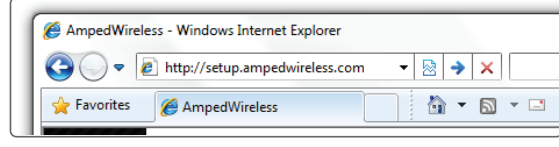

Enter the setup web address into your browser:

<http://setup.ampedwireless.com>

If the URL fails to open, then try: <http://192.168.1.240>

Recommended browsers: Google Chrome, Safari or Internet Explorer (8.0 and up). Do not use Firefox.

#### IF YOU HAVE PROBLEMS ACCESSING THE WEB MENU...

Disconnect your PC from wireless networks, open your browser and try again.

##### Windows 7 & Vista (example)

- Click on the Wireless icon to see available wireless networks (For Vista, click Start > Connect To).
- Select your current wireless network and click **Disconnect**.
- Power the Range Extender off and back on and try <http://setup.ampedwireless.com> again.

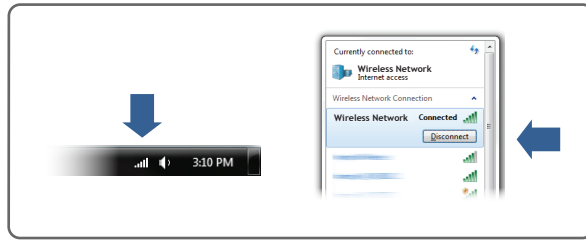

If you are still having trouble accessing the web menu, disconnect the cable from your computer to the Range Extender. Connect wirelessly using the **SSID: Amped\_SR** and **Password: wireless** and try again.

Accessing the Smart Setup Wizard does not require Internet access. The menu is served from the Range Extender.

### 4 Welcome to the Smart Setup Wizard

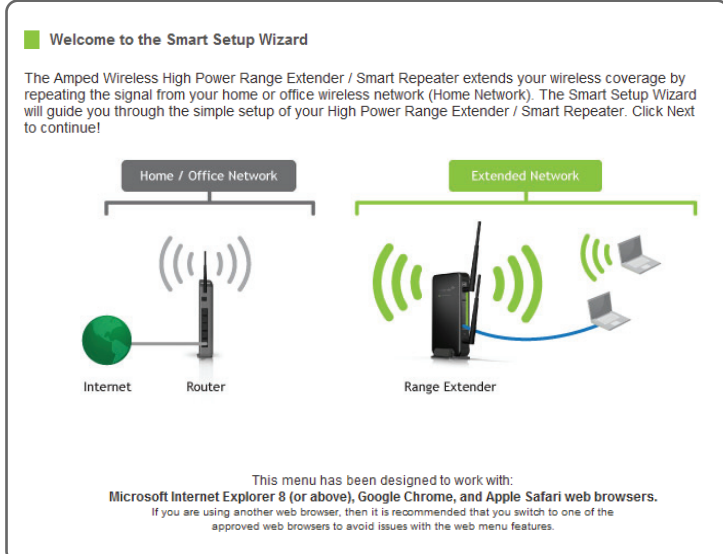

The wizard will guide you through the setup of your Range Extender.

Click **Next** to begin.

### 5 Scan for a Wireless Network to Repeat

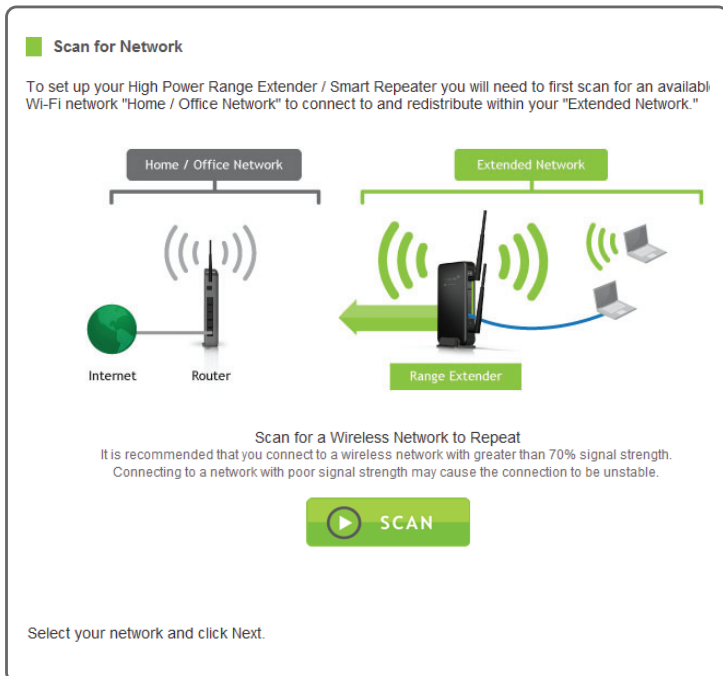

Click **Scan** to begin scanning for nearby wireless networks.

Highlight and select the wireless network that you wish to repeat.

**Recommended Signal**  
**>70%** Select the wireless network with a signal strength greater than 70% for the most reliable connection.

Poor signal connections may cause slow speeds or dropped connections.

Click **Next** to continue.

If you do not see your desired wireless network, move the Range Extender closer to the router and scan again as it may be out of range.

### 6 Home Network Security Settings (If necessary)

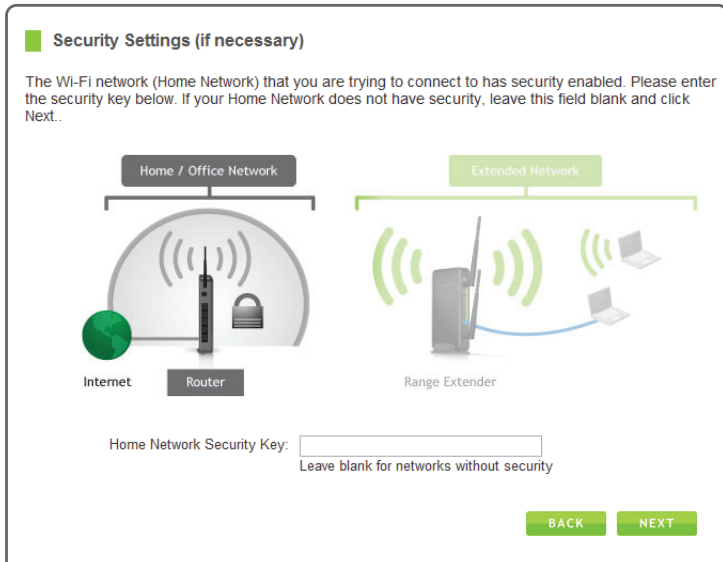

If your wireless home network has security enabled, you will need to enter the security key here.

If your wireless home network does not have security enabled, leave the security field blank.

Click **Next** to continue.

### 7 Configure Settings for your Extended Network

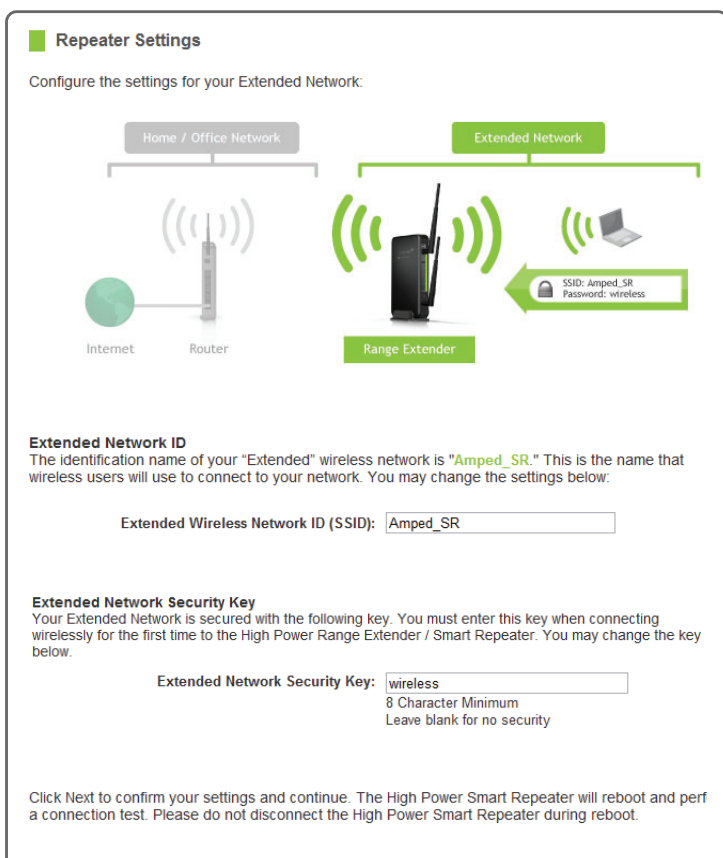

The ID of your Extended Network is: **Amped\_SR**

To change it, enter a new name in the SSID field. Users connecting wirelessly to the Range Extender will use this ID to identify your Extended Network.

The default Security Key (WPA) of your Extended Network is: **wireless**

To change it, enter a new key in the Security Key field. The key must be at least 8 characters long.

Click **Next** to apply your settings. The Range Extender will reboot. This process may take up to 2 minutes. Do not refresh the web page. The page will automatically reload with the connection status.

### 8 Setup Summary

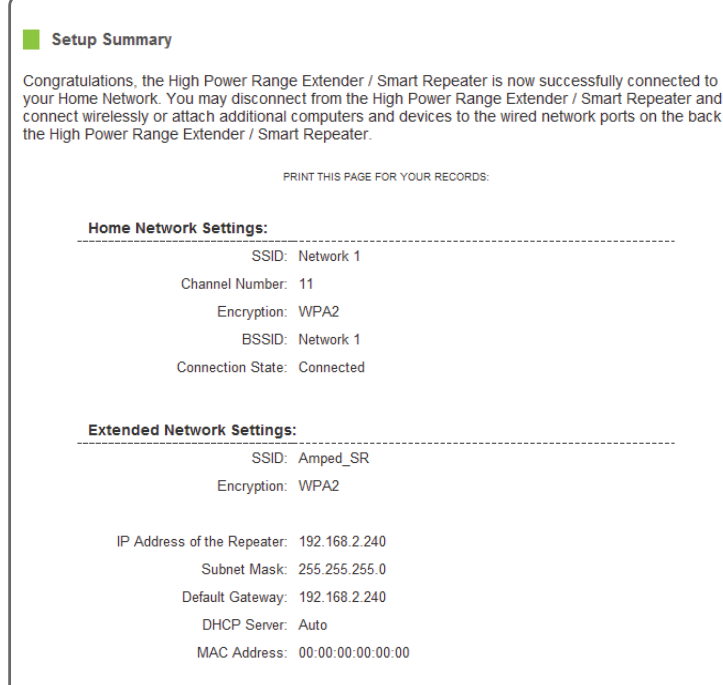

Congratulations, the Range Extender is now successfully configured. Your settings are now saved. You may now detach the Ethernet cable from your computer and connect wirelessly to the Range Extender.

If you haven't already positioned your Range Extender in an optimal location, you may do so now. All Range Extender settings are saved and can be safely powered off for relocation.

You may also attach any wired network devices to the wired ports on the back of the Range Extender.

If there was a problem with your configuration, the Smart Setup Wizard will inform you to restart the Wizard and select another network to repeat. If you continue to experience problems, please contact Amped Wireless Elite Support:

Phone: 888-573-8820  
Email: [techsupport@ampedwireless.com](mailto:techsupport@ampedwireless.com)  
Web: [www.ampedwireless.com/support](http://www.ampedwireless.com/support)



## How to Connect your Wireless Computer to the Range Extender

### Windows 7 and Vista

A. Click on the Wireless icon to see available wireless networks (For Vista, click Start > Connect To). Select the "Amped\_SR" network and click **Connect**.

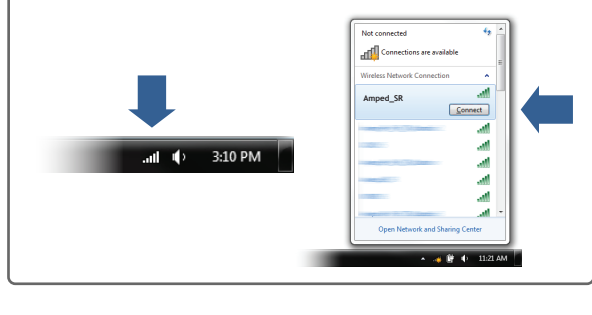

B. When prompted, enter the wireless security key "wireless" and click **OK**.

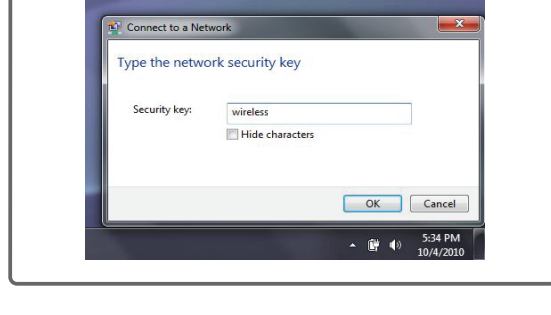

### Mac OS X

A. Click on the Wireless icon to see available wireless networks. Select the "Amped\_SR" network and click **Connect**.

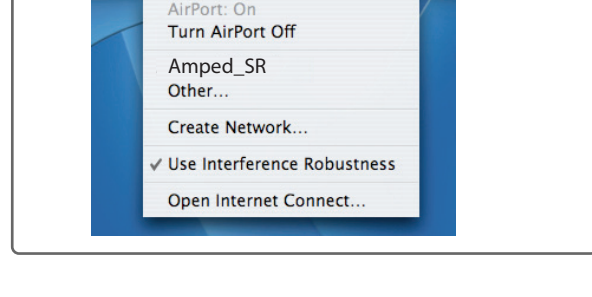

B. When prompted, enter the wireless security key "wireless" and click **OK**.

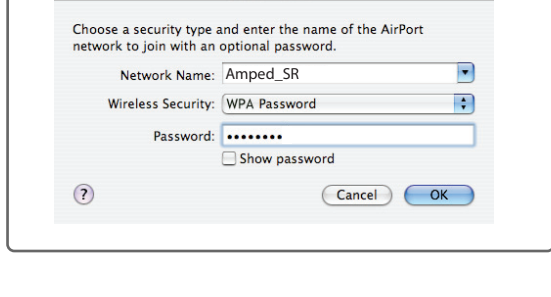

## Wi-Fi Protected Setup (One-Touch Setup or Push Button Configuration)

If your wireless adapter has WPS one-touch setup you can use it when connecting to the Range Extender. Hold down the WPS button on the Range Extender (back panel) for 3 seconds. The WPS LED will begin to blink. As it blinks, push the WPS button on your wireless adapter or enable WPS with the provided software for your wireless adapter.

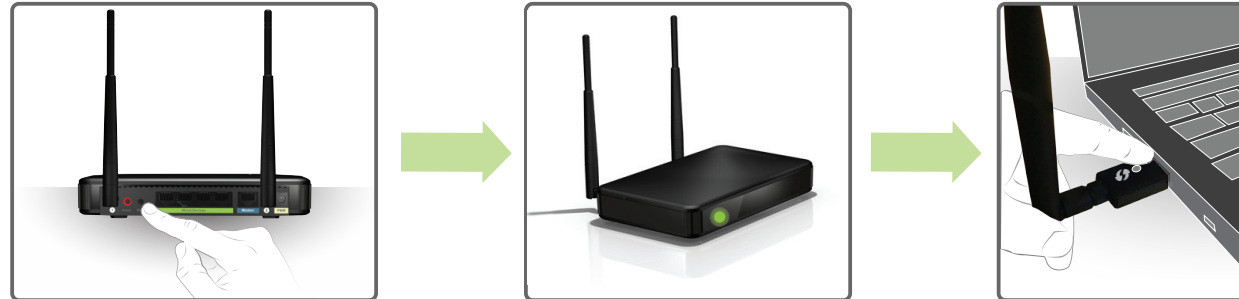

## Using the Smart Features on your Range Extender

The Range Extender is equipped with many powerful security features which can be accessed through the web menu under **Smart Features** on the left side of the web menu:

<p>Web Menu (Left Side)</p>	<p><b>Wireless Access Scheduling</b> Control when your Wi-Fi is on/off Menu Location: Smart Features &gt; Access Schedule</p>
	<p><b>User Access Control</b> Restrict network access to specific users Menu Location: Smart Features &gt; User Access</p>
	<p><b>Wireless Coverage Control</b> Adjust the distance of your wireless network Menu Location: Smart Features &gt; Wireless Coverage</p>

If you are unfamiliar or want more information on how to set up Smart Features, please refer to the User's Guide on the included CD.

## Setting the Range Extender's System Clock

In order for your Access Schedules and logs to perform using the correct time stamps and schedules you will need to set your System Clock. To do so, go under **Management** and access the **System Clock** tab to sync the System Clock with your computer time.

System Clock

Maintain the system clock settings by syncing the system time with the time on your computer. The Smart Repeater's clock is used to make sure your Access Schedules and logs function correctly and on time.

Current Time:  Month  Day  Year  
 Hour  Minute  Sec

Sync with your computer:

## Tips: Trouble Accessing the Smart Setup Wizard

**PROBLEM:** The Setup Wizard does not appear when you enter the setup web address.

Enter the setup web address into your browser:  
**http://setup.ampedwireless.com**

If the URL fails to open, then try: http://192.168.1.240

What you can try:  
[Diagnose Connection Problems](#)  
[More information](#)

**SOLUTION:** Disconnect your computer from all Wi-Fi networks and try again.

Your computer should be connected to the Range Extender with the included Ethernet cable.

- Disconnect your computer from all wireless networks.
- Enter **http://setup.ampedwireless.com** into your web browser again.

NOTE: Your computer does not need Internet to access the Smart Setup Wizard.

### Windows 7:

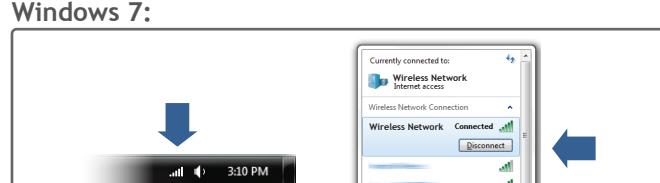

Click the Wireless Signal icon from bottom right corner. Select your network and click Disconnect.

### Windows XP:

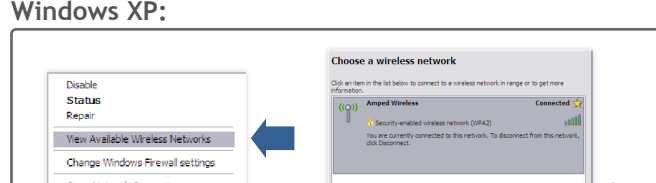

Right click the Wireless Signal icon from bottom right corner. Click View Available Wireless Networks, select your network and click Disconnect.

### If you continue to have problems accessing the Smart Setup Wizard:

- Reboot the Range Extender, disconnect your computer from all wireless networks and try again. If this fails, try...
- Disconnect the cable from your computer to the Range Extender. Connect wirelessly to the Range Extender's wireless network: **Amped\_SR**. When prompted, enter the security key: **wireless**. Open your web browser and try: **http://setup.ampedwireless.com**. If this fails, please contact our support department for assistance.

## Tips: Power Outages, Rebooting Routers and Channel Changes

Wireless routers operate on specific wireless channels to avoid interference with neighboring networks. Some wireless routers are set to automatically scan for the best wireless channel. A power outage, or a simple reboot, may cause your home wireless router to change its wireless channel and cause the Range Extender to disconnect from your home network.

To fix this issue, simply log onto the Range Extender's web menu by opening your web browser and accessing **http://setup.ampedwireless.com**. If the page does not load, try resetting the Range Extender by holding down the reset button on the back panel for five to ten seconds. After the Range Extender has rebooted, open your web browser and try again.

When the web menu appears, run through the Smart Setup Wizard again to reconfigure the connection to your Home Network.

To prevent the channel changing issue from occurring in the future, you may log onto your router's web menu and set the wireless channel from Automatic to a static channel number. You will need to reconfigure the Range Extender with the new channel. If you are not sure how to access your router's web menu, contact the support department for the brand of your wireless router.

## Tips: Autoloading Web Menu

When the Range Extender loses its connection with your Home Network, the Web Menu will automatically load on your web browser. All web address entries will be redirected to the Smart Setup Wizard of the Range Extender. This feature is meant for you to easily reconfigure your Range Extender in the event of a disconnection. This feature may be disabled in the IP Settings menu of the web menu. The feature is titled: Auto-DNS.

## Troubleshooting Tips

**PROBLEM:** I cannot connect to my Home Network. I received an error when running the Smart Setup Wizard.

**SOLUTIONS:**

- Your Home Network may be secured. Double check that you have the correct security key to connect to the Home Network.
- Try adjusting the channel number of your Home Network's router to channel 5 thru 11. Then attempt the Smart Setup Wizard again.
- Reboot your Home Network router and try to connect again using the Smart Setup Wizard.
- Check to see that your Home Network router's DHCP server is enabled. The Range Extender needs to obtain an IP from your Home Network router.

**PROBLEM:** My Range Extender was working fine previously, but now I can no longer access the Internet through the Range Extender.

**SOLUTIONS:**

- The connection to your Home Network may have been dropped or the router settings may have changed. Changes to the router could be a result of several events, such as a power outage. When this occurs, connect to the Range Extender and access the setup menu using the web address: **http://setup.ampedwireless.com**. Run the Smart Setup Wizard to reconnect the Range Extender to your network.
- Using the setup menu (**setup.ampedwireless.com**) check to see that the signal strength between the Range Extender and your home network is above 70%. The Range Extender may be too far from your home router and not maintaining a signal strength of above 70%. Check the signal strength between the router and the Range Extender through the web menu (left side): More Settings > Management > Repeater Status. The Signal Strength readout will be under the Home Wireless Network Settings section. This Signal Strength must be above 70%. If it is below, move the Range Extender closer to your router, or reposition the Range Extender.

**PROBLEM:** I cannot find my Home Network when scanning for wireless networks in the Smart Setup Wizard.

**SOLUTIONS:**

- The Range Extender may be out of range. Move the Range Extender closer towards the wireless router and try the Setup Wizard again from the web menu.
- Make sure that your Home Network's wireless SSID is broadcasting and not hidden. Hidden SSIDs will require that you manually enter the SSID into the Wireless Settings > Network menu.

If you continue to have issues setting up the Range Extender, give us a call — we're here to help: 888-573-8820  
Visit our website for more support information and answers to frequently asked questions: [www.ampedwireless.com/support](http://www.ampedwireless.com/support)